

## HARDWARE PACKAGE

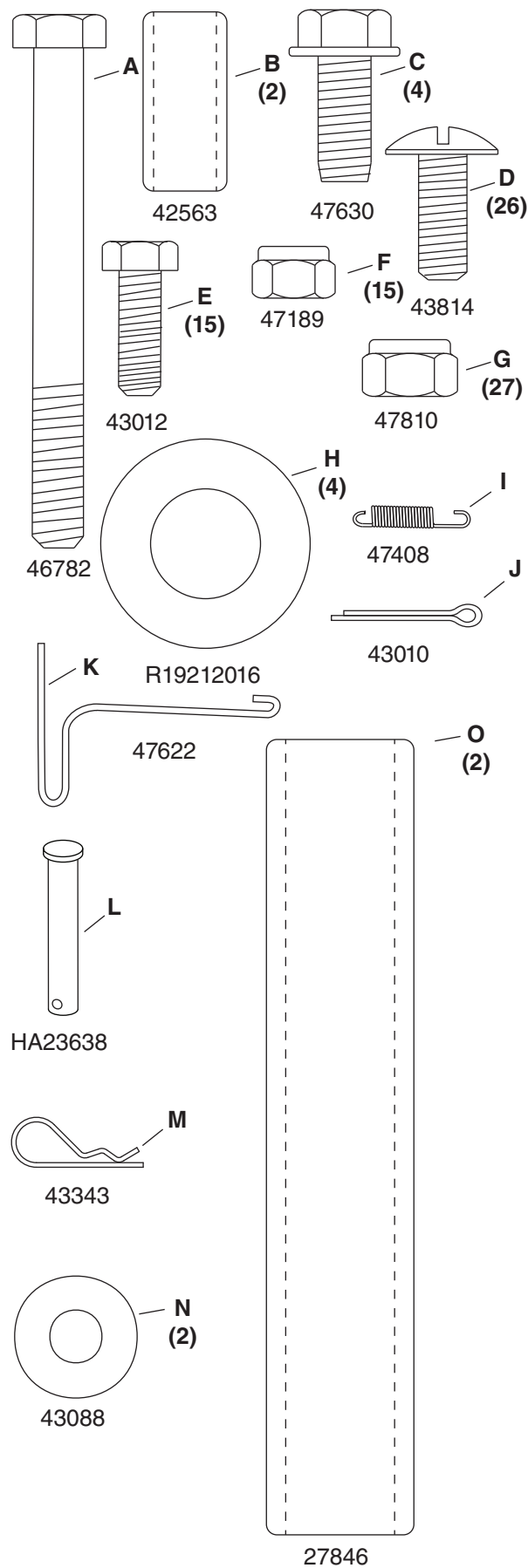

**STEP 1 (SEE FIGURE 1):** Assemble the cart body using three 1/4" x 3/4" hex bolts (E) and 1/4" nylock nuts (F). **Do Not Tighten!**

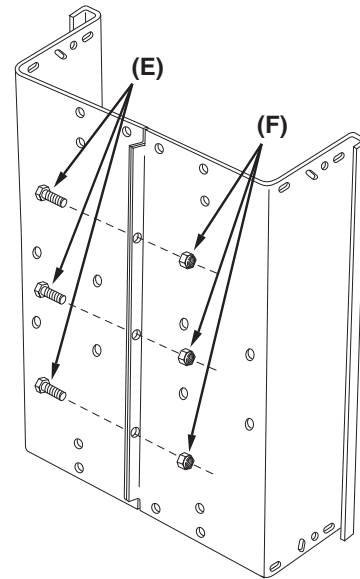

Figure 1

**STEP 2 (SEE FIGURE 2):** Attach the lower rear angle bracket (4) to the assembled cart body using four 5/16" x 3/4" truss head bolts (D) and 5/16" nylock nuts (G). **Do Not Tighten!**

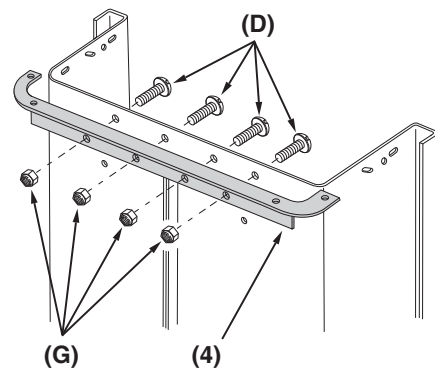

Figure 2

**STEP 3 (SEE FIGURE 3):** Attach the left (2) and right (3) rear angle brackets to the cart using two 1/4" x 3/4" hex bolts (E), 1/4" washers (N), and 1/4" nylock nuts (F). **Do Not Tighten!**

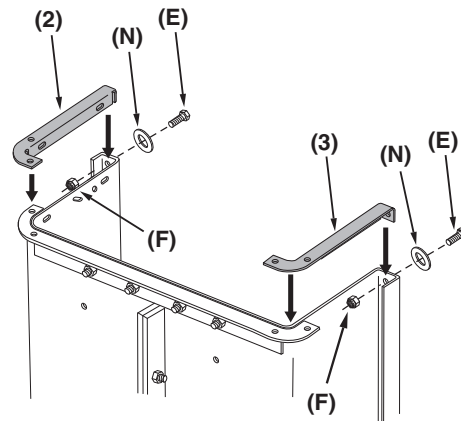

Figure 3

**STEP 4 (SEE FIGURE 4):** Attach the tailgate guides (6) using four 1/4" x 3/4" hex bolts (E) and 1/4" nylock nuts (F). **Do Not Tighten!**

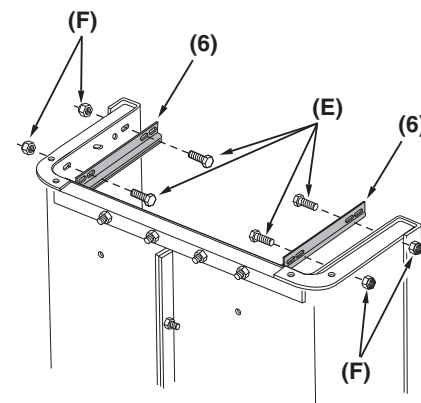

Figure 4

**STEP 5 (SEE FIGURE 5):** Temporarily install two 1/4" x 3/4" hex bolts (E) and 1/4" nylock nuts (F) into the holes as shown in figure 5.

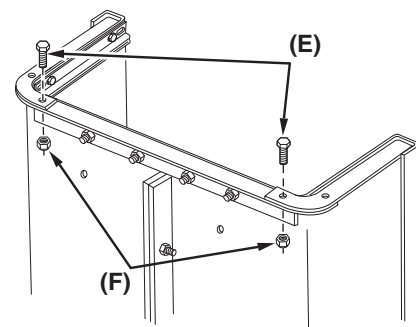

Figure 5

**STEP 6 (SEE FIGURE 6):** Secure the left and right rear angle brackets to the lower rear angle bracket using two 5/16" x 3/4" self tapping bolts (C). Be sure that there is no gap left between the angle brackets as shown in figure 6.

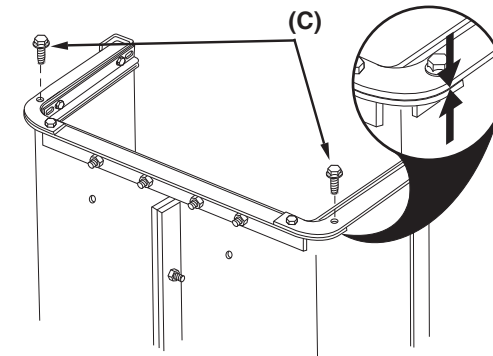

Figure 6

**STEP 7 (SEE FIGURE 7):** Remove (E) and (F) installed in Step 5.

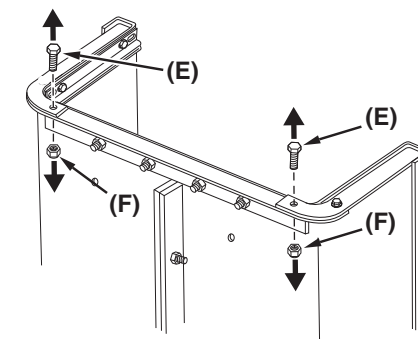

Figure 7

**STEP 8 (SEE FIGURE 8):** In the remaining holes, install two 5/16" x 3/4" self tapping bolts (C) until the angle brackets are drawn together leaving no gap between the angle brackets as shown in figure 8.

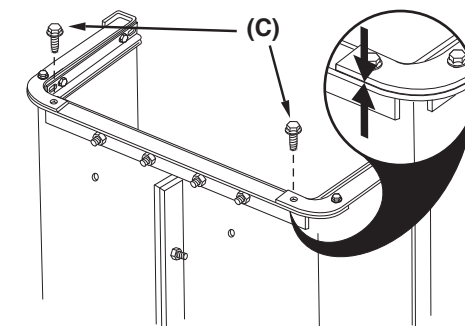

Figure 8

**STEP 9 (SEE FIGURE 9):** Tighten all fasteners from previous steps.

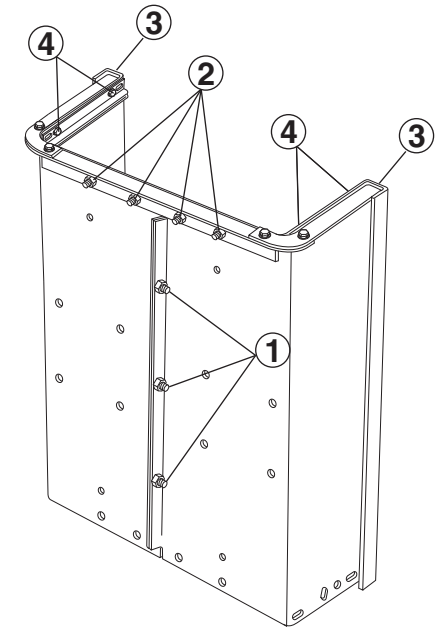

Figure 9

**STEP 10 (SEE FIGURE 10):** Position the cart bed with the rear towards the ground as shown in figure 10.

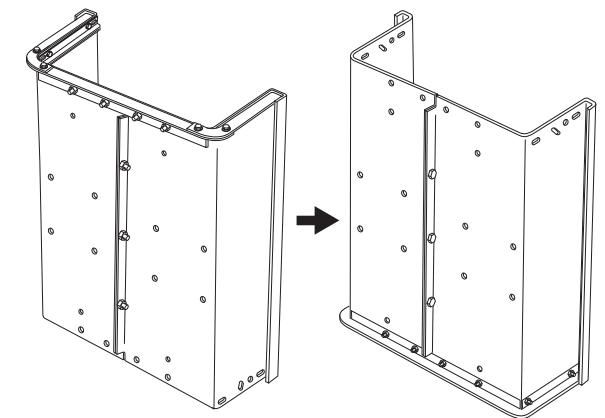

Figure 10

**STEP 11 (SEE FIGURE 11):** Attach the front panel (8) to the front of the cart bed using six 1/4" x 3/4" hex bolts (E) and 1/4" nylock nuts (F).

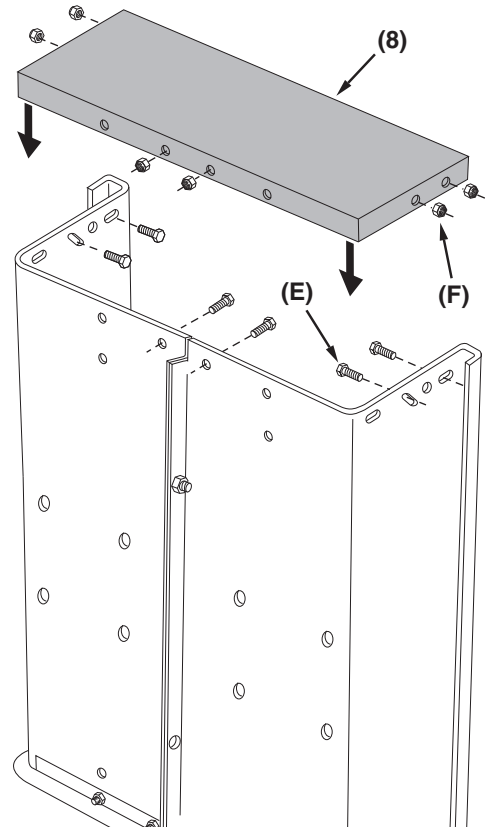

Figure 11

**STEP 12 (SEE FIGURE 12):** Attach the bed supports (7) to the cart and attach the wheel supports (10) to the bed supports (7) using eight 5/16" x 3/4" truss head bolts (D) and 5/16" nylock nuts (G).

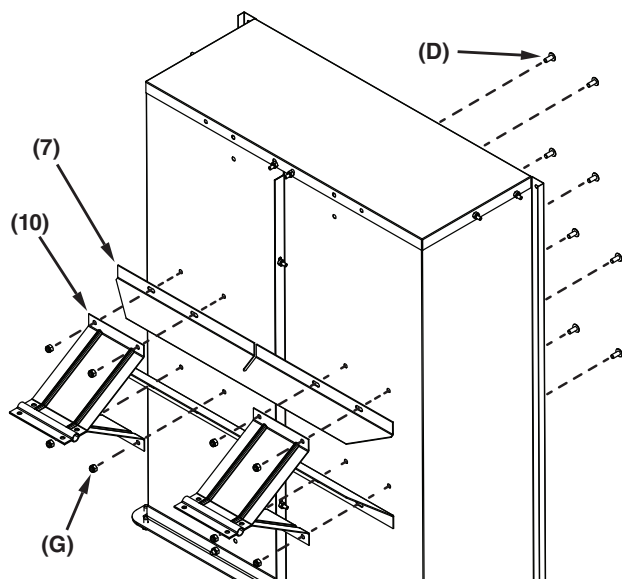

Figure 12

**STEP 13 (SEE FIGURE 13):** Secure the wheel supports using eight 5/16" x 3/4" truss head bolts (D) and 5/16" nylock nuts (G). **Do Not Tighten!**

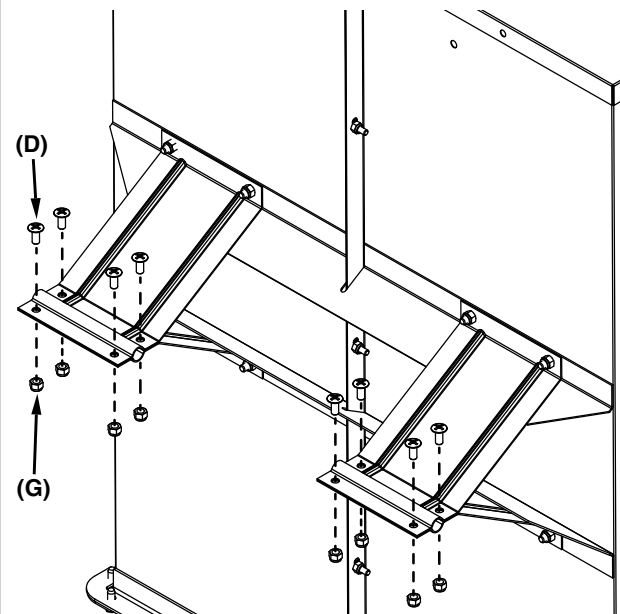

Figure 13

**STEP 14 (SEE FIGURE 14):** Attach the latch stand bracket (9) to the cart bed and front panel (8) using four 5/16" truss head bolts (D) and 5/16" nylock nuts (G). Make sure to orient the tab on the latch stand bracket as shown in figure 14.

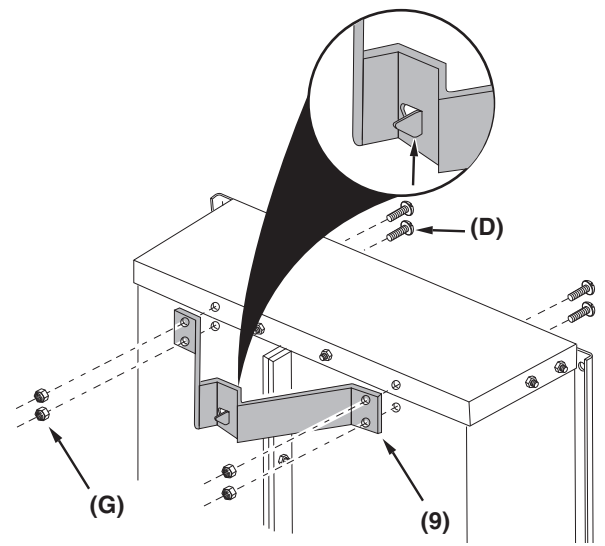

Figure 14

**STEP 15 (SEE FIGURE 15):** Position the cart bed upside down and place the draw bar tongue (14) as shown in figure 15.

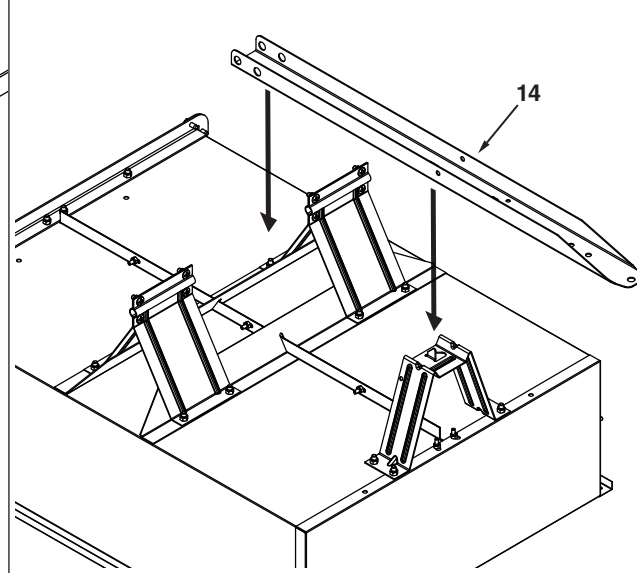

Figure 15

**STEP 16 (SEE FIGURE 16):** Install the axle (11) through the wheel support, a spacer (O), the draw bar tongue (14), a spacer (O), and the wheel support as shown in figure 16.

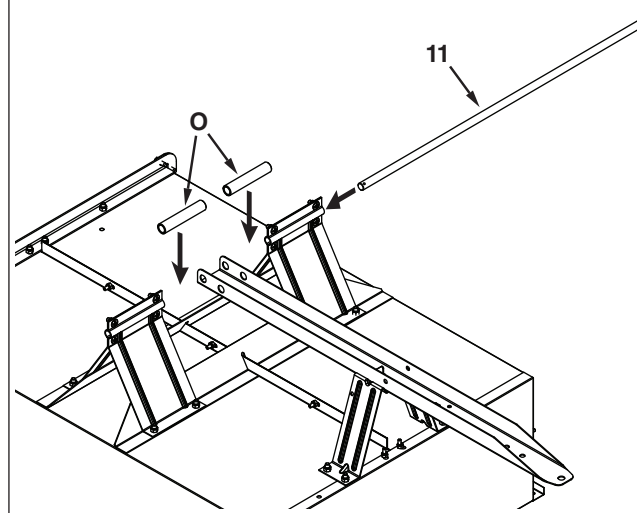

Figure 16

**STEP 17 (SEE FIGURE 17):** Attach the wheels to the axle by installing a large washer (H), a wheel (12), another large washer (H) and a 1/8" cotter pin (J). Repeat this step for the other side.  
**Note: Be sure to lubricate the axle ends before attaching wheels.**

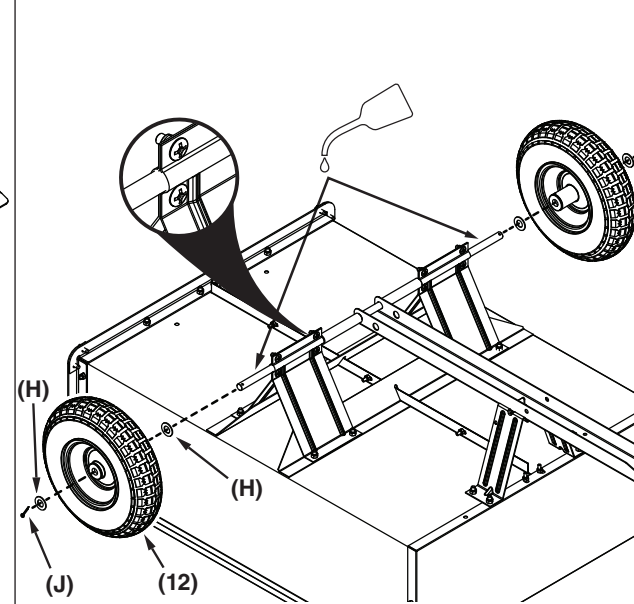

Figure 17

**STEP 18 (SEE FIGURE 18):** Install the latch lock lever (13) by inserting a 5/16" x 3" hex bolt (A) through one side of the draw bar tongue (14), a spacer (B), the latch lock lever (13) a spacer (B), the other side of the draw bar tongue (14), and a 5/16" nylock nut (G) as shown in figure 18.

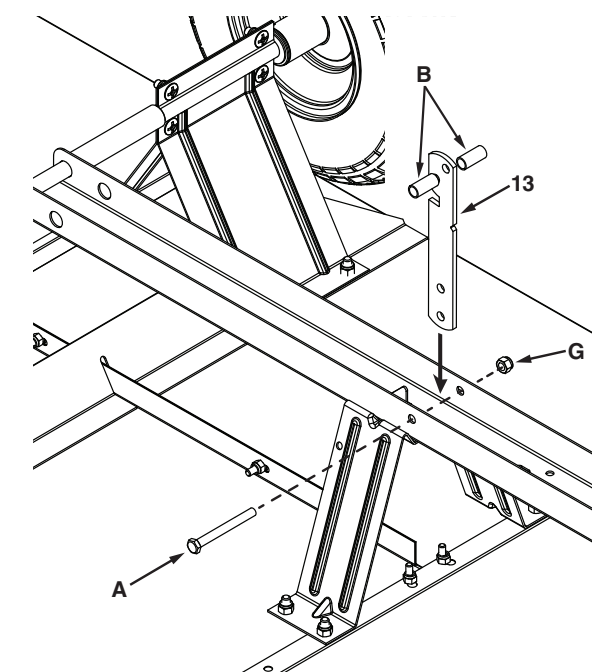

Figure 18

**STEP 19 (SEE FIGURE 19):** Attach the extension spring (I) to the latch lock lever by inserting one end into the hole in the latch lock lever. Using the spring puller tool (K), attach the other end of the extension spring (I) to the square hole in the draw bar tongue as shown in figure 19.

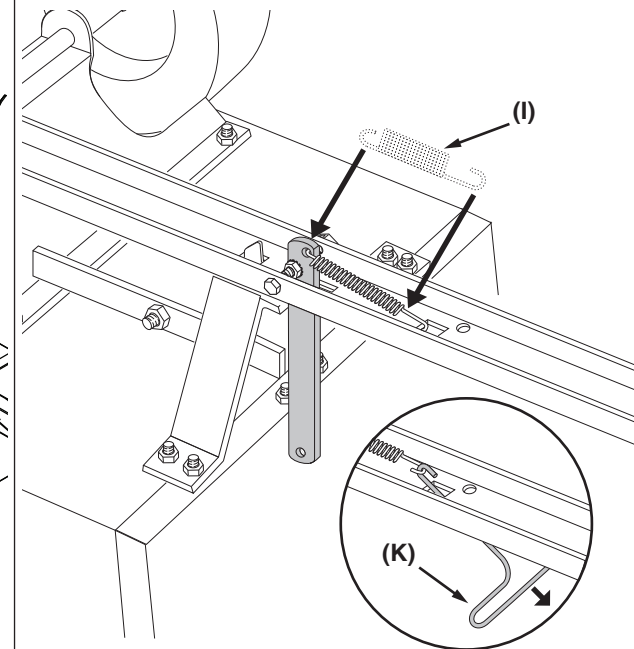

Figure 19

**STEP 20 (SEE FIGURE 20):** Attach the hitch bracket (15) to the draw bar tongue using two 5/16" x 3/4" truss head bolts (D) and 5/16" nylock nuts (G). Install the hitch pin (L) through the holes in the hitch bracket (L) and the draw bar tongue and secure with a 1/8" hair cotter pin (M).

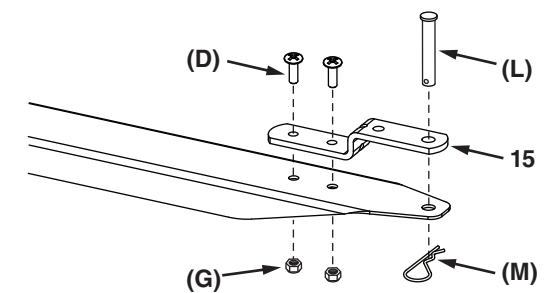

Figure 20